



THIRD BRAKE LIGHT ANTENNA MOUNT

90201188, 90201189- Third Brake Light Antenna Mount



*Lens is not included

Fits the 2021-2023 Ford Bronco

INSTALLATION MANUAL

INTRODUCTION

Thank you for your purchase of our vehicle specific Third Brake Light Antenna Mount! We hope that you find the installation simple and straight forward. As our customer, your satisfaction is important to us, and for that reason we take pride in all of the products that we design and manufacture to ensure a reliable solution for years to come!

Pre-caution

Upon completing the installation of the Third Brake Light Antenna Mount the overall height clearance of the vehicle will have changed. Beware of your surroundings and heed all height restriction warnings as they pertain to your vehicle to avoid damage to the antenna, adapter or even vehicle.

Warranty

With regards to our Third Brake Light Antenna Mounts, we offer a 1-Year Parts-Only Warranty.

The limitations include:

- Parts-only, exchange-only warranty.
- Warranty is limited to defects in workmanship and materials.
- Shipping is NOT included with warranty returns.

In the rare event that you might actually have a warranty claim, we will be more than happy to assist you. Please call before you take action. We want to track and properly handle any warranty claims. You will need to contact our team at 888-967-6653 or 480-247-2331 and we will help you with your options and return.

Tools needed for installation

- 4mm Allen Head
- 5mm Allen Head
- 13mm Wrench
- T25 Torx Head
- T40 Torx Head
- T30 Torx Head
- Panel Popper
- 19mm Socket and Breaker Bar
- Two medium Zip Ties



NOTE:

Installation of the antenna mount may be possible with one person, although having a helper is highly recommended.

Parts List - 90201188, 90201189

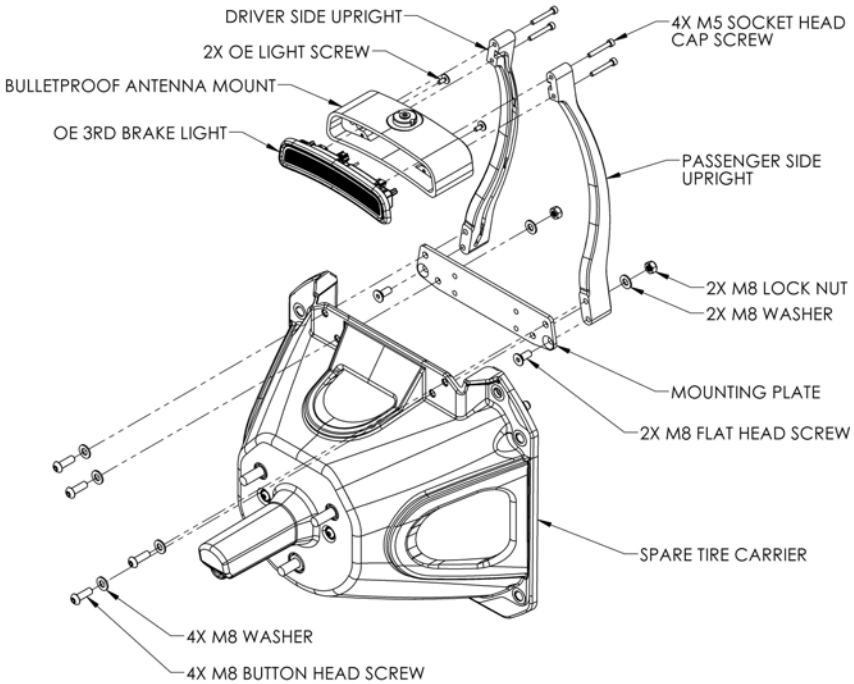

| Part# | Description | Qty. |
|-------------|-------------------------------------------------|------|
| 65021102 | BRONCO ANTENNA MOUNT | 1 |
| 35 OR 37 IN | DRIVER SIDE SUPPORT | 1 |
| 35 OR 37 IN | PASSENGER SIDE SUPPORT | 1 |
| 6502134 | BRONCO ANTENNA MOUNTING PLATE | 1 |
| 6200247 | M5 X 0.8 X 35MM SOCKET HEAD CAP SCREW (ZINC) | 4 |
| 6200248 | M8 X 1.25 X 20MM FLAT HEAD SCREW | 2 |
| 6200249 | M8 X 1.25 X 25MM BUTTON HEAD SCREW, BLACK OXIDE | 4 |
| 6200017 | M8 X 1.25 X 8MM NYLON LOCK NUT | 2 |
| 6200016 | M8 WASHER | 6 |

INSTALLATION STEPS:

Step. 1 Using a breaker bar and 19mm socket, remove the spare tire.



Step. 2 Remove the third brake light assembly; 4 screws to separate the assembly from the tire carrier, then 6 screws to separate the assembly and access the third brake light connector and the brake light lens.



Step. 3 Gently pry the wire clip loose from the housing and disconnect the third brake light connector.

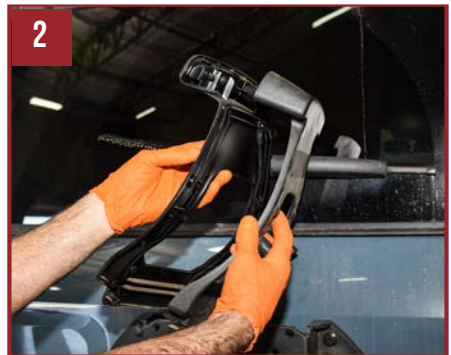
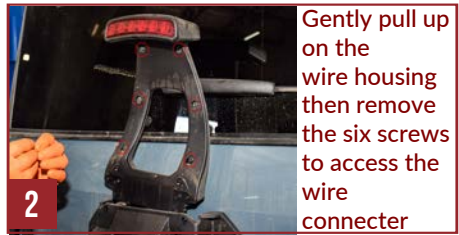



Step. 4 Remove the brake light lens from the housing. Keep the screws, they will be reused in the new housing.

Step. 5 Route the brake light wiring through the drivers side of the antenna mount.



Step. 6 Plug in the third brake light, then slide the third brake light into the antenna mount housing.



Step. 7 Install the two factory screws you saved from step 4.





Step. 8 Slide the third brake light wiring into the driver's side antenna mount leg. Slide the leg into the antenna mount. Secure the leg by using two of the provided M5 Cap Screws.

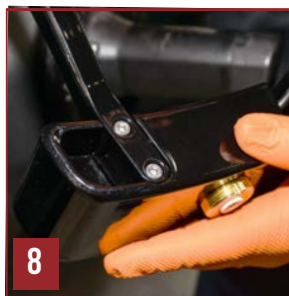
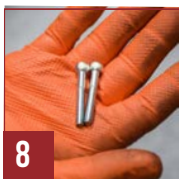
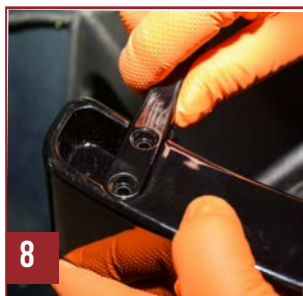

Step. 9 Slide the antenna cable into the passenger side antenna mount leg and slide the leg into the antenna mount. Secure the leg by using the two remaining M5 Cap Screws.



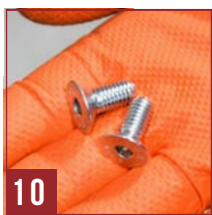

Step. 10 Using the steel bracket provided, install the provided Flat Head Screws into the bottom holes of the antenna mount legs as shown.



Step. 11 Slide the antenna mount assembly behind the factory spare tire holder line up the holes and install two of the provided torx screws and washers into the two top holes.

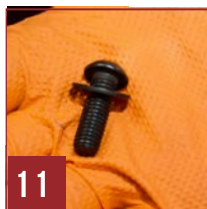

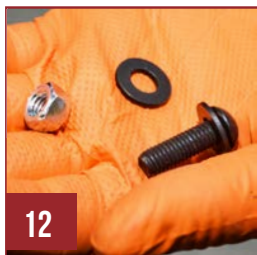

Step. 12 Now, install the other two torx screws with washers through the two lower holes in the plastic spare tire holder and install the provided nuts and washers to the back to secure the mount.



Step. 13 Remove the interior trim pieces inside the door. **TIP** - Pry from the bottom of the long piece and the left of the vertical piece to avoid breaking clips.



Step. 14 Route the antenna cable to the inside of the truck through the cab vent. Fish through the inside of the door and zip tie the wire to the existing cables.

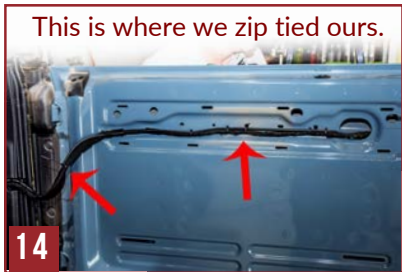

This is where we zip tied ours.

Step. 15 Replace the interior panels and make sure all the hardware has been tightened.



HANDETRACK

CARRY CARGO
SAFELY, SECURELY, & EASILY
ACROSS ANY TERRAIN

TWO OPTIONS

5/16

OR

1/4

- 18 THREAD

- 20 THREAD



480.247.2331 • 888.967.6653 • bulletproofdiesel.com





@bulletproofdest



480.247.2331 * 888.967.6653 * bulletproofdiesel.com

